

Programming Lemonade in the BUNN Juice Dispenser

RECOMMEND THAT TWO PEOPLE CONDUCT PROGRAMMING: ONE PERSON READS INSTRUCTIONS WHILE THE SECOND PERSON PERFORMS THE TASKS



Getting Started

The following Getting Started steps should be completed as soon as possible to allow sufficient time for the juice machine to be repaired and/or any parts to be replaced, if necessary **BEFORE All Store Selling Date.**

1. Verify restaurant has the minimum required parts for each BUNN juice machine (*illustration 1*) and that all parts are clean in good working condition.
2. Verify both sides of the machine are working. If you are not currently using both sides for OJ, the easiest way to do this is to move the drawer holding OJ concentrate to opposite position (e.g. Top to Bottom).



Illustration 1

Program Lemonade

1. Load a bag of lemonade into the machine (*illustration 3*). Dispense a few times to confirm the product is dispensing. For optimal performance, we recommend placing lemonade in the **bottom tray**.
2. Gather supplies (*illustration 2*):
 - a. Calibration cup (sent to restaurant with training materials)
 - b. Flat blade screwdriver
 - c. Small clear cup to place screws in
3. Remove the **drip tray** and the **splash panel**. Splash panel is held in place with 2 screws at the bottom. Put the screws in a safe place; they will not be replaced until all programming steps are complete.
4. Locate the button under **Program**. Push it to the left to enter the **programming mode**. Display on door will read **"PRO."**
5. Put the splash panel in place (without replacing the screws). Replace the drip tray (the drip tray will keep the splash panel in place). **NOTE:** This step is required to prevent product splashing onto the control panel and damaging the machine.
6. Place the calibration cup on the drip tray under the nozzle **on the side that lemonade will dispense from**. Press and release the **small** portion size button **3 times**. Measure and record the amount of water that dispenses here oz Discard water.
7. Press and release the **small** button **6 times**. Measure and record the amount of lemonade that dispenses here oz Discard product.



Illustration 2



Illustration 3

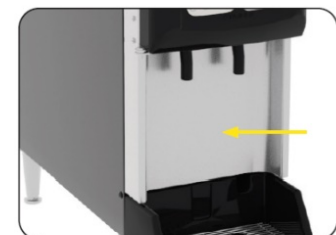

Lower Splash Panel

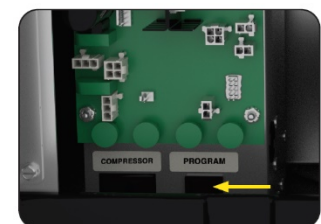

Program Switch

8. Refer to the **Ratio Target Chart below**. If the **Target Total Volume** (collected in step 5) matches the corresponding **Water Only Volume** column (collected in step 4), proceed to **step 10**.

Lemonade Ratio Target Table	
Approximate water amount dispensed during test	Adjust finished product amount as close to possible to target
9.00 – 9.50 oz.	11.5 oz.
9.50 – 10.00 oz.	12 oz.
10.00 – 10.50 oz.	12.5 oz.
10.50 – 11.00 oz.	13 oz.
11.00 – 11.50 oz.	14 oz.

9. If the **Target Total Volume** is higher or lower than the **Water Only Volume**, calibration needs further adjustment. Remove the **drip tray** and the **splash panel**.
10. Locate the two **adjustment knobs** located above **Compressor**. If lemonade dispenses from the right side of the machine, use the knob on the right side. If lemonade dispenses from the left side, use the knob on the left side. **NOTE: Do not** use the knobs located above **Program**.
11. Turn the **adjustment knob** in small increments, clockwise to increase or counterclockwise to decrease. Continue to adjust until the **Product Volume** is correct.
12. Repeat calibration process (**steps 6 thru 11**) and make adjustments as necessary until the **Measured Volumes** are correct.
13. Apply **Lemonade label** to the juice machine (labels were included in your training kit).
14. Proceed to **Setting Portion Controls**.

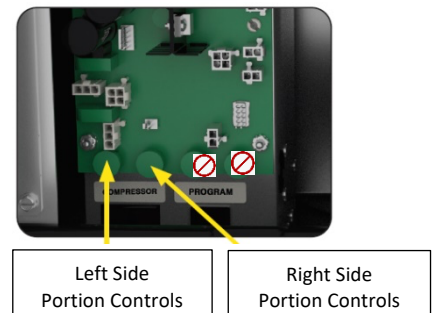

Setting Portion Controls for Lemonade in BUNN

RECOMMEND THAT TWO PEOPLE CONDUCT PROGRAMMING: ONE PERSON READS INSTRUCTIONS WHILE THE SECOND PERSON PERFORMS THE TASKS

1. **On the side that will dispense lemonade**, press and hold the small portion size button until you hear **3** beeps, then release. Display on door will read **"POR."**
2. Place empty calibration cup under the dispensing head. Press the **SMALL** portion size button to begin dispensing lemonade, release it to stop dispensing when the cup is filled to **8.5 ounces**. If the small button is stopped and the level is not set to **8.5 ounces**, empty the calibration cup and repeat this step until the small portion size button is accurately set to **8.5 ounces**.
3. Place empty calibration cup under the dispensing head. Press the **MEDIUM** portion size button to begin dispensing lemonade, release it to stop dispensing when the cup is filled to **13.5 ounces**. If the medium button is stopped and the level is not set to **13.5 ounces**, empty the calibration cup and repeat this step until the medium portion size button is accurately set to **13.5 ounces**.
4. Place empty calibration cup under the dispensing head. Press the **LARGE** portion size button to begin dispensing lemonade, release it to stop dispensing when the cup is filled to **18 ounces**. If the large button is stopped and the level is not set to **18 ounces**, empty the calibration cup and repeat this step until the large portion size button is accurately set to **18 ounces**.
5. Place empty calibration cup under the dispensing head. Press the **Ex LARGE** portion size key to begin dispensing lemonade, release it to stop dispensing when the cup is filled to **5 ounces**. *This button will be used for requests for sweet tea lemonade and unsweetened tea lemonade.* If the **Ex LARGE** button is stopped and the level is not set to **5 ounces**, empty the calibration cup and repeat this step until the **Ex LARGE** portion size button is accurately set to **5 ounces**.
6. Exit the programming mode by pushing the **Program** button to the **right**. The display on door will show the cabinet **temperature**.
7. Remove the drip tray.
8. Replace the two screws on the splash panel.
9. Replace the drip tray.

